

- SITE BOUNDARY
- PRO. SVB. DIVISION
- ROADS.

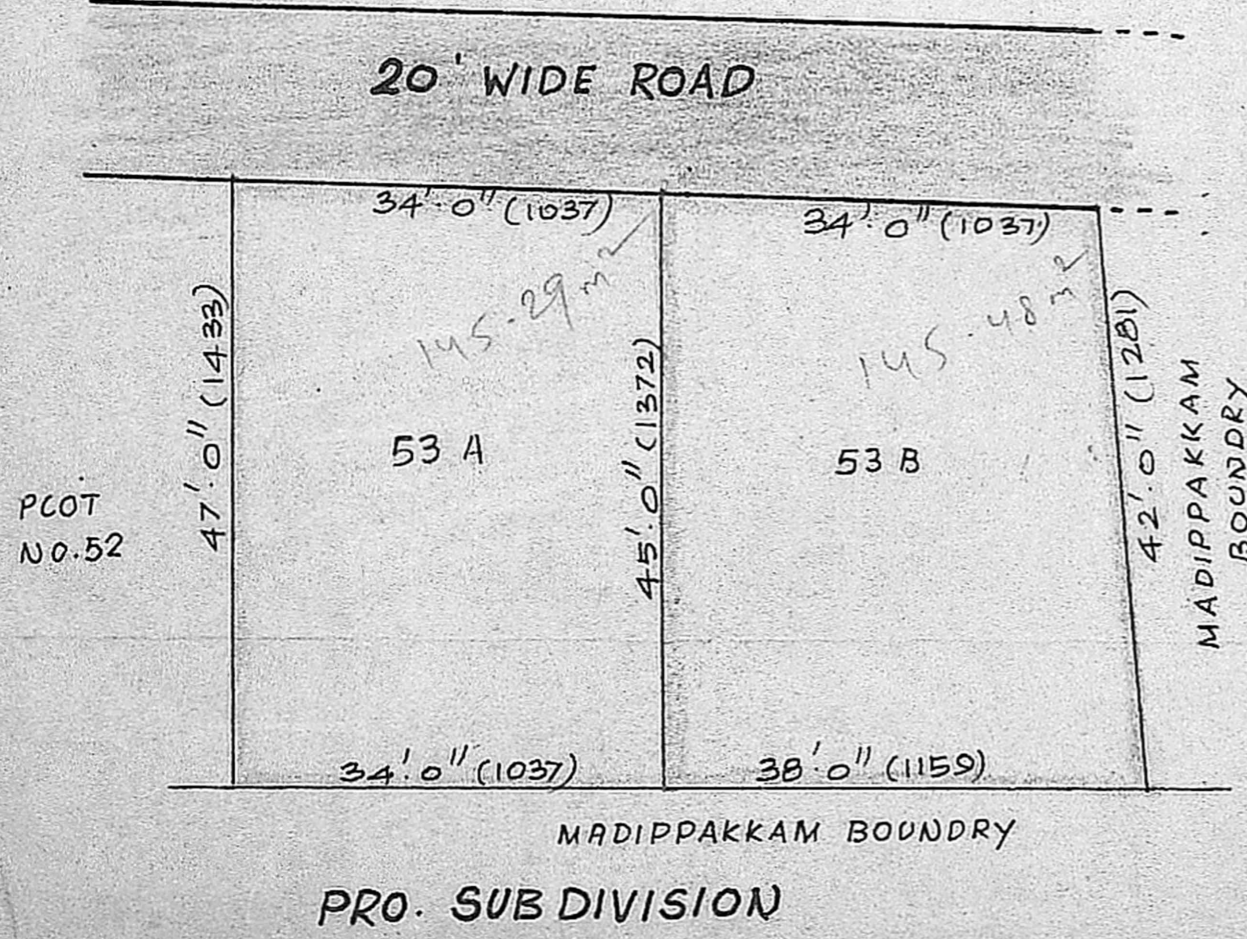

30' ALANDUR - MADIPPAKKAM MAIN ROAD

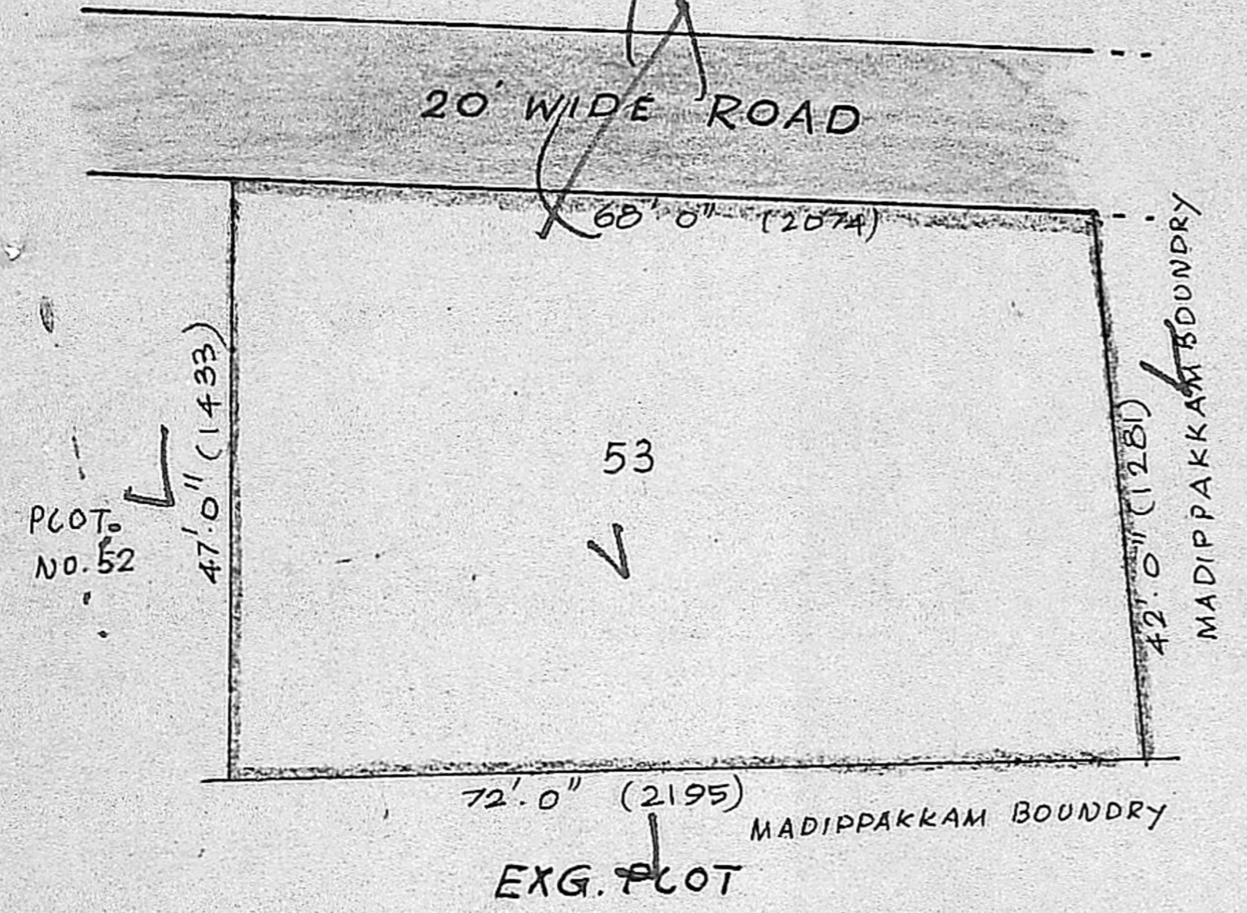
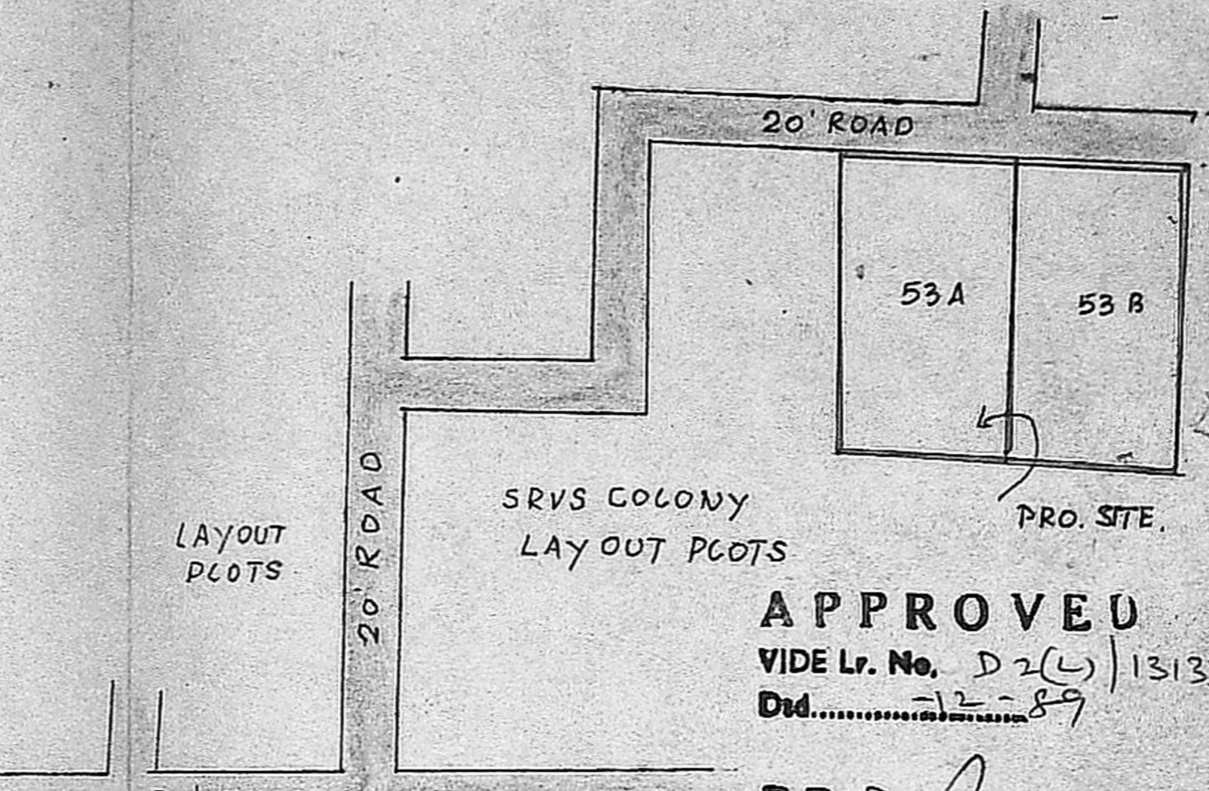

**APPROVED**  
 VIDE Lr. No. D 2(L) 13133/89  
 Dtd. 12-89

P.P. D No. 295  
 L.O. No. 89

FOR MEMBER SECRETARY  
 MADRAS METROPOLITAN  
 DEVELOPMENT AUTHORITY

4/12/89  
 2/5/12  
 Stanley

PLAN SHOWING THE PROPOSED  
 SUB DIVISION OF LAND INTO 2  
 PLOTS AT PLOT NO 53. S. NO. 259/3  
 OF KEELAKATTALAI VILLAGE  
 (PALLAVAPURAM MUNICIPALITY)

SCALE 1 INCH TO 16 FEET

P. Mani  
 (P. MANI)  
 OWNER

V. RAMAMURTHY  
 LICENCED SURVEYOR  
 TAMBARAM MUNICIPALITY  
 NO. 15, PANCHAYAT COLONY  
 GHROMPET, MADRAS - 600 044.

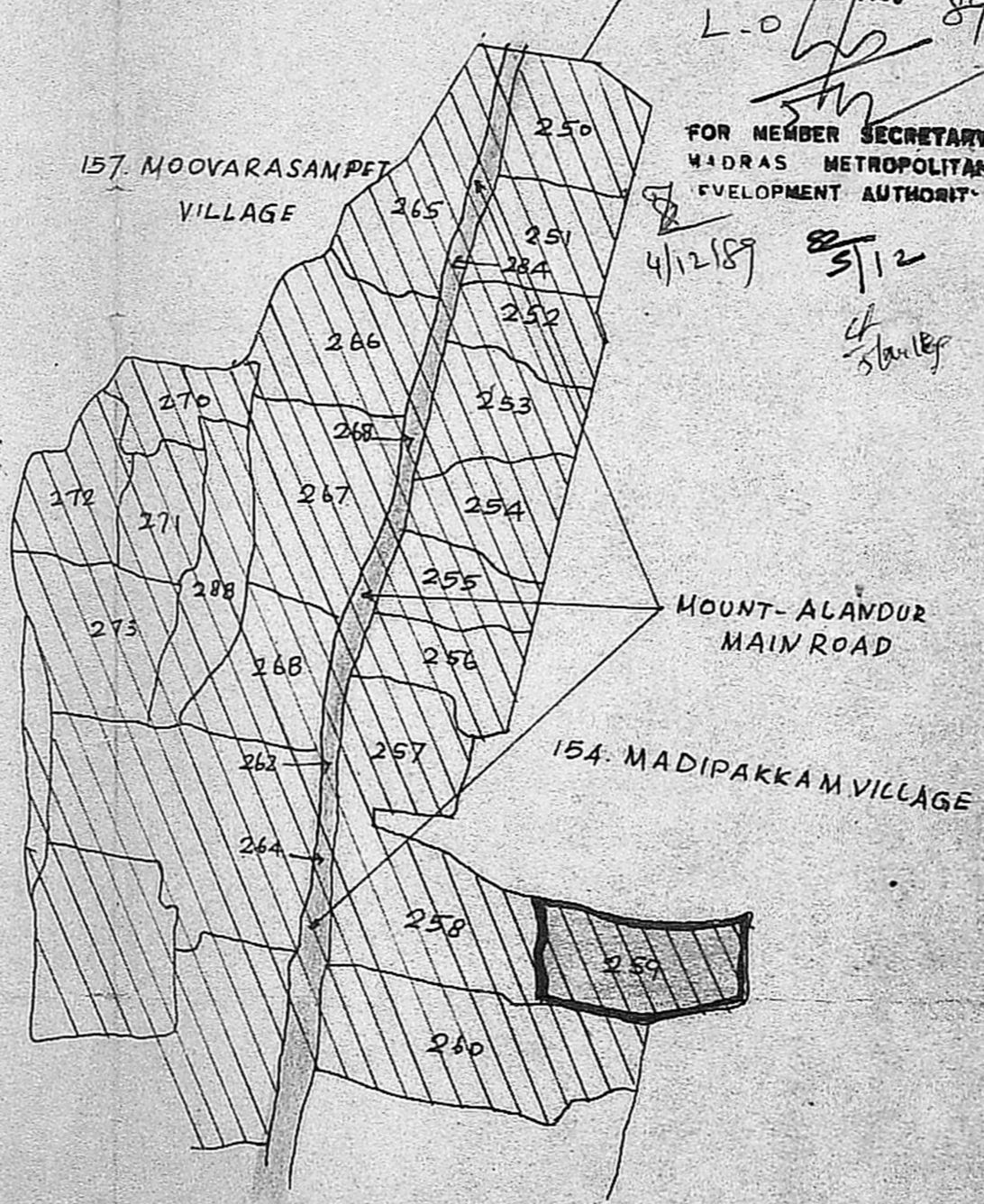

EXTRACT OF THE MMDA LAND USE MAP

